



# Konini School

## Prospectus

### 2020



## Nau mai, Haere mai - Welcome to Konini School

On behalf of the Board of Trustees and Staff I welcome you to our school. We will provide your child with a learning environment that is fun, engaging and purposeful. We want all our learners to leave Konini School at the end of Year 6, confident and ready for the next challenge in their educational journey.



Our strategic goals centre around the three simple headings of; Learning, Culture and Environments. Our goals are interwoven and provide us with our guiding values.

At Konini School we value;

- Child centred learning which leads to engagement, motivation and inspiration
- The importance of building strong, positive, respectful relationships
- The importance of creativity, play and fun in Primary School education
- Maximising the use of our learning environment to provide authentic learning opportunities
- Our environment and recognise the importance of building and embedding sustainable practices
- Cultural identity and celebrate the unique differences, talents, values and perspectives we all possess

We are very proud of our school and the strong relationship we have with our community. We look forward to you joining the Konini whanau.

Andrew Ducat  
Principal



### About us...

Konini School opened in May 1976 as a full variable teaching space school. As is the case in education, policies and philosophies change, and with that the original open plan lay out of the classrooms reverted to single cell teaching spaces. Additional buildings were added, with the most recent arrival being the senior school block in 2014 which is reflective of the current thinking around collaborative teaching. In total, Konini School has 23 classrooms/learning spaces.

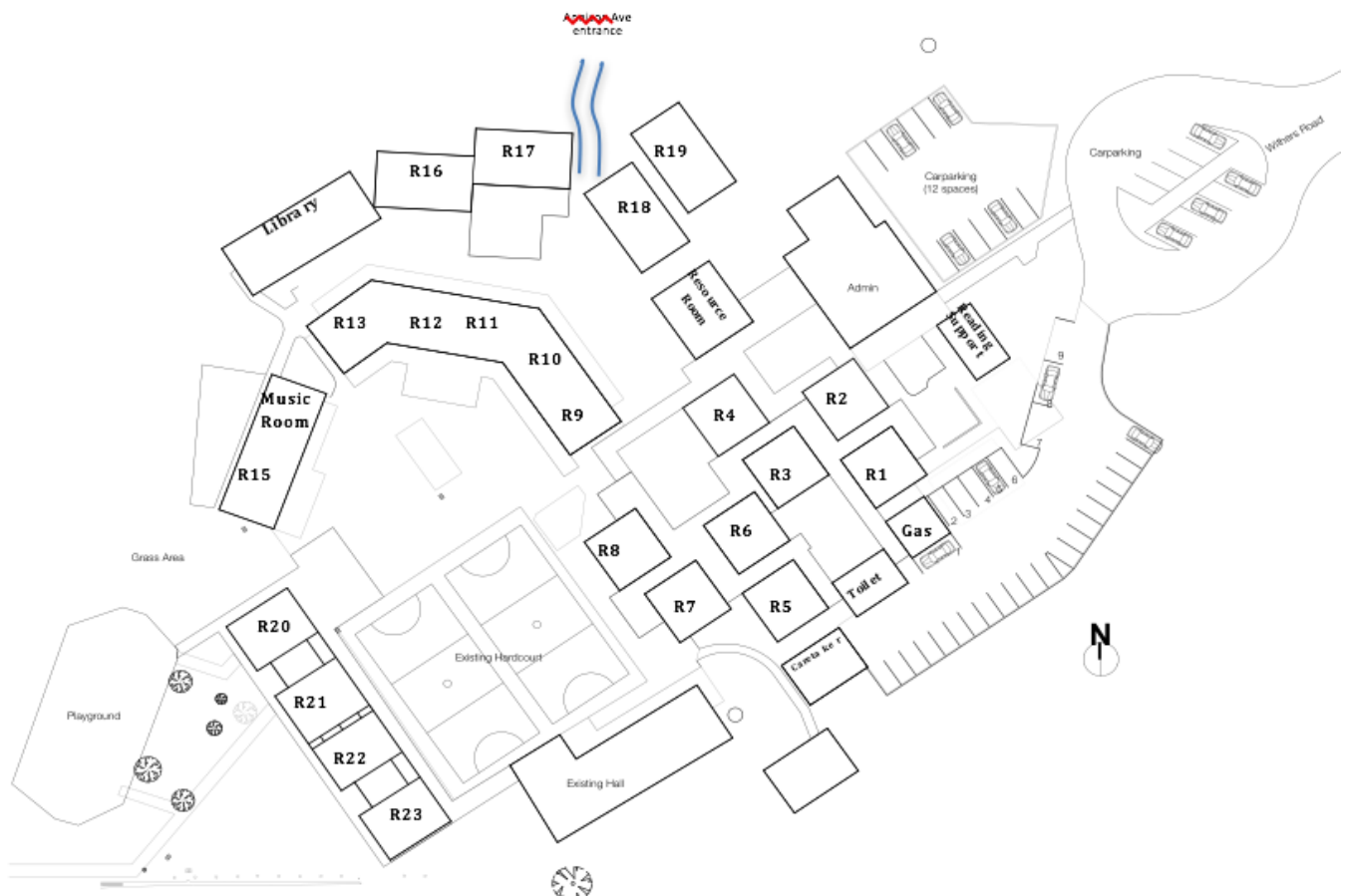

We have the capacity to cater for more than 500 pupils but manage the school roll so that we reach the end of year target of 450 through the out of zone ballot process. Our school zone has been in place since 2013. Our goal in managing our roll is to ensure that Konini School maintains a small school feel while still providing a rich and vibrant curriculum.

Konini School has a unique physical environment which provides our students with a wealth of rich, authentic learning experiences without even having to leave the school grounds. Neatly nestled at the end of Withers Road our school sits proudly on 8.5 hectares of land, half of which is native bush which adjoins the foothills of the Waitakere Ranges. The Whakarina stream weaves its way through the upper reaches of our bush area, fed by a gentle 4 metre high waterfall which surrounding rock faces provide home to our resident glow worms.



We have our very own mountain bike track which makes its way around the school field before heading up to the Story Tree then completing a loop trail to our waterfall. As part of the Bikes in Schools programme we have 60 mountain bikes so every child has the opportunity to gain confidence developing their cycling skills while at Konini School.



Our extensive enviro gardens, including plant nursery are a special feature of our school that we are particularly proud of and, along with the wonderful art work on display around the school, reflect our commitment to the Enviro Schools programme.

Our school grounds are well maintained and widely used by the Konini community in the weekend.



As well as placing a strong focus on reading, writing and mathematics we also recognise the importance of developing healthy, creative learners which is why we offer a rich Arts and Physical Education programme. We employ specialist members of staff to provide all our learners with engaging Dance, Music and Physical education related sessions.

### School Hours

Classrooms open for pupils at 8.30am. Please do not arrive before then. The school day is divided into 3 learning blocks.

#### 8.50am

9.00am – 11.00am  
11.00am - 11.10am  
11.10am - 11.30am  
11.30am – 1.00pm  
1.00pm – 1.40pm  
1.40pm – 1.50pm  
1.50pm – 3.00pm  
3.00pm

#### School starts

Block 1 (brain food break just before 10.00am)  
The whole school sits down to eat morning tea  
Morning tea play  
Block 2  
Lunch time play  
The whole school sits down to eat lunch  
Block 3  
Home time





## Te Pou

As you enter the school through the main entrance you will see Te Pou, standing tall and proud, kaitiaki of our kura.

**Kawerau ā Maki** (The Chief), sits at the top of the pou holding a vessel. He is wearing a tūke or kete filled with kumara which encompasses the tikanga around the name – Te Kawerau ā Maki.

**Matāhu** (The Warrior) A fierce warrior, sits underneath **Kawerau ā Maki**, as he is his younger brother. Matāhu was instrumental in many victories, helping to build the status of mana whenua in the Tāmaki region.

**Teautewhenua** (The Peacemaker), sits at the base of Te Pou. Teautewhenua is mokopuna of Kawerau ā Maki and was dedicated to improve the well being of his people.



## Konini A to Z

### Absences

We use an electronic attendance system and have to follow-up on any unexplained absences from school on the day of the absence. If your child is absent for any reason, please phone the school and leave a message, e-mail [office@konini.school.nz](mailto:office@konini.school.nz) or text 021 038 1685 with an explanation of the absence before 9.00 am. We will phone or text you if your child is away and we have not heard from you.

### Accidents

Minor accidents are treated in the medical room in the admin block. Parents are contacted if the accident is of a more serious nature. If parents/caregivers cannot be contacted and the school deems that the child needs urgent attention the school will either phone for an ambulance or take the child to an emergency health centre.

### After & Before School Care/Holiday Programme

Live and Learn provide an onsite before and after school care and holiday programme. Live n Learn are based in the school hall.

For more information contact Renee or Jasmine on 022 175 875 or email [rene@livenlearn.co.nz](mailto:rene@livenlearn.co.nz)

### App

The Konini School Application (App) is a tool to keep you connected to the Konini School community and help make communicating with teachers, the office and senior management a seamless task.

How do I sign up?

Find your App store on your phone or Ipad and search 'Konini Primary School'. Download the App and explore the different features.

### Assemblies

We host whole school assemblies fortnightly on a Friday morning where we share items and celebrate achievement. Whanau are encouraged to attend. Please check the school newsletter or website for dates. Teams also host their own assemblies on a regular basis. At the start of each term, we also hold a mihi whakatau to welcome new whānau to Konini.

### Bikes & Scooters

Children can ride bikes and scooters to school if they wear a helmet and are supervised by their parent. Year 3-6 students are allowed to bike or scooter to school by themselves if they have parent permission. We have bike and scooter racks next to Room 19. Please note that we do not allow children to ride their bikes or scooters around the school grounds during school hours.



### **Board of Trustees**

Our Board of Trustees meet monthly in the staffroom. Meeting dates will be included in school newsletters and through the website. BoT meetings are public meetings which you are welcome to attend. Minutes of the Board of Trustees meetings and copies of the School Charter are available to parents/caregivers at the school office. Policies and procedures can be viewed on our Schooldocs link at [koninis.schooldocs.co.nz](http://koninis.schooldocs.co.nz).

Login – Konini

Password – Withers

### **Concerns**

Most concerns parents have regarding your child's learning or wellbeing can be managed by speaking with your child's teacher. Please approach them as soon as possible if you have any concerns. If the problem is complex or you would like further dialogue, please feel free to contact a member of the Senior Leadership Team.

### **Cyber Safety**

We have high expectations for all children around the safe and appropriate use all electronic devices. We teach all children that if they come across anything on screen that they know they should not be looking at to immediately close the screen and ask a staff member for help. From Year 4 upwards, pupils and whānau are required to sign a cyber safety agreement annually. This is an important reminder for pupils and whānau to discuss safe protocols when accessing the internet.

### **Dental Therapist**

The mobile dental clinic visits the school annually. Appointments can also be made at the dental facility at Glen Eden Intermediate by phoning 8180070. For emergencies you can phone 0800TALKTEETH to arrange an appointment.

### **Donations**

We have opted into the Government's school donation scheme which means that we do not request a donation from whānau at the start of the year. The scheme also covers costs associated with school trips and school related activities, such as the Life Education Caravan. The only costs we ask of parents is for optional activities, such as private music lessons and afterschool or weekend sports related activities. School camps are not included under the Government's school donation scheme

### **Education Outside the Classroom**

Team and class trips play a very important part in the school programme. Parent help is often needed to ensure that trips are safe. Please let the class teacher know if you are willing to help. On school trips it is not possible or appropriate to accommodate pre-school children. From time to time there will be local trips, e.g. to Ceramco Park or Kowhai Reserve, for which parental permission is not sought.

### **Emergency Procedures**

We regularly practice emergency procedures such as fire drills and lockdowns, so that in the unlikely event of a real emergency, children and staff are well prepared.



## **English as a Second Language Programme**

The Konini School community is reflective of modern day Auckland. As a school, we are enriched through the many different cultures that make up our school community. We receive specific funding from the Ministry of Education which we use to support children who come from homes where English is not the first language. Ms Vanderwee and Whaea Vikki manage our ESOL programmes.

## **Enrolment of Pupils**

We encourage all pre-school children to enrol well before their fifth birthday. An Enrolment form can be collected from the office. If you have any questions regarding starting school, the office staff, or a member from the Senior Leadership Team are more than happy to help. When we enrol a child we take a photocopy of their original birth certificate. We also take a copy of their immunisation certificate. As we operate an enrolment zone, we also require proof of address upon enrolment. Pre-school visits are strongly encouraged for new entrant children. Whaea Vikki runs a transition to school programme called Kotahi every Wednesday morning from 8.45am-10.30am. The purpose of Kotahi is to help make the transition from Early Childhood Education to Primary School as seamless as possible.

## **Friends of Konini School**

Wanting to help out at school but not wanting to join a committee? How about putting your name down as a Friend of Konini School. All you need to do is to contact Karen or Debbie in the office and let them know that you are able to help out. Some of the jobs that we always need help with at school include; cooking and serving sausages on Fridays, helping to put away junior reading resources, helping in the library and listening to children read as part of our whānau reading programme. We also appreciate help with our Enviro-schools programmes.

## **Hats**

All children at Konini are required to wear a wide brimmed hat in terms 1 and 4. We have a strict sun safe policy in place at school which states that no pupils are allowed to play outside in in Term 1 and 4 without a hat. If they do not have a wide brimmed hat then they must play in the shaded areas.

## **Health and Safety**

Please let us know if your child has any medical conditions which may impact on their learning or their general health. You may have indicated this on the enrolment form but if anything else becomes evident, please let us know so that we can keep your child safe. If your child needs medication at school, please see the office staff. It is important that you provide the school with accurate and up to date information regarding contact details in case the office staff need to call you.

## **Homework**

At the start of the year each syndicate will advise you of homework expectations through syndicate newsletters and at the first meet the teacher evening. Homework is not compulsory and should never become a cause for arguments at home. It should be a positive, sharing experience. If you have concerns regarding homework, please speak with your child's teacher.





### **Late Pass & Early Pick Up**

Children who arrive at school after 8.50 am are asked to sign in at the office. If it becomes necessary to collect your child early we have a sign out process. Please speak to Karen or Debbie in the office. They will issue you with a slip to take to your child's teacher.

### **Library**

We are very fortunate to have a well-resourced and attractive library which every class can access each week. Our library is a popular place for all children to visit and is open at morning tea and lunch time. Pupils are encouraged to withdraw up to 2 books each week, as long as they have returned previously issued books.

### **Lost Property**

All lost property that has been collected during the term is on display on a moveable trolley. The trolley is located opposite Room 2, on the main thoroughfare through the school. We make every effort to return clothing to owners, but this is very difficult if clothing is not named. After a period of time, unclaimed items are donated to the Salvation Army.

### **Mobile Phones**

We do not encourage children to bring mobile phones/watches to school, however, if you need your child to bring in a phone/watch they are required to hand the device in to the office at the start of the day.

### **Music in School**

Some of our children receive private music instruction during the school day. This is entirely optional and separate from the school programme. If you are interested in looking into private music instruction contact NZ School of Modern Music on 834 4155.

### **Newsletters**

The school newsletter is emailed to the community fortnightly on a Thursday and contains information about upcoming events, celebrations and important school notices. Newsletters can also be viewed on our website or via the Konini App. To ensure you receive the school newsletter please make sure that we have your current email address.

### **Parent Help**

On any given day we have a number of volunteer parents helping out at school. We welcome parent volunteers and value the great work they do. If you would like to help at school please contact Karen or Debbie in the office or Whaea Vikki. Some of the ways you may be able to help at Konini include; whānau reading (reading support), in class support, help with school trips, library assistance, coaching of school sports teams, gardening and supporting our Enviro education programmes.



## Parking

Before and after school parking can be problematic due to congestion and parking restrictions. It is important that we collectively take responsibility for the safety of all children and community members as they make their way to and from school each day. There is plenty of unrestricted parking available at the badminton court carpark, which is only a short walk to the school entrance. Further along Withers Road, and outside the Annison Avenue entrance, parking restrictions are in place before and after school. Please take notice of the parking restrictions and help reinforce the road safety messages we teach all our children.



**All parking before and after school is restricted to 10 minutes along Withers Road.**



**Do not stop on the raised crossing for drop offs and pick-ups.**



**No parking or stopping on the yellow lines. We instruct children not to enter cars here. Stopping here blocks traffic and the disability park.**



**No parking or stopping on the yellow lines. Please be courteous of our neighbours by not blocking drive-ways.**



**Remember that there is a no parking zone outside the Annison Ave Entry/Exit.**



## **PTA**

The PTA at Konini do a great job supporting school events and coordinating fundraising efforts throughout the year. The PTA is made up of a committee of parents and are fully supported by the Board of Trustees and Staff. Meetings are held twice a term. The committee are always looking for new members who are prepared to help the school in a variety of ways – from helping to cook sausages through to helping out at a school disco. Contact Karen or Debbie in the office if you are interested in helping the school. Most of the school's fundraising is organised by the PTA.

## **Positive Behaviour for Learning**

Konini School is a Positive Behaviour for Learning (PB4L) School. PB4L underpins everything we do. It is interwoven in the values that shape and maintain our school kaupapa. To foster a culture of mutual respect and achieve high expectations for student behaviour and learning we;

- Maintain a school environment that is positive and supportive
- Ensure that expectations are consistently clear
- Recognise and celebrate expected behaviours
- Teach expectations
- Demonstrate consistency and fairness when responding to inappropriate behaviour

As a PB4L School we work hard to ensure that all children understand what our school rules and values are. We recognise that we all can make mistakes and work closely with children to ensure that they take responsibility for their actions. When we break a rule, we use the following phrase;

**We take responsibility for our actions at Konini. When we make a mistake we;**

**Own it**

**Fix it**

**Learn from it**

## **Reporting to Whanau**

We report on student learning through two ways – formal written reports and learning celebrations (student led conferences).

Written reports are sent home at the end of term 2 and at the end of term 4. Learning celebrations take place in term 1 in term 3.

## **Safety of Students**

Your child's safety is our prime concern. We therefore strongly promote zero tolerance to violence and bullying in our school. This means that no one person has the right to intimidate any person in any way. It also means that it is okay to speak up if you are being bullied. We encourage pupils to share their concerns with an adult they trust.



### **Special Needs**

We can access help from various agencies for children with speech, hearing, severe behaviour and/or learning needs. Please contact Whaea Vikki (Deputy Principal) or Maura O'Shea (Learning Support Coordinator) for more information.

### **Sports**

We provide plenty of opportunities for all children to take part in physical activity and sport. We have external providers that regularly come in to deliver sessions with each class. Older children are encouraged to become involved in our inter-school sports teams. Trudy Ingoe leads the Sports Team and, along with coaching many of our teams, coordinates all our inter-school teams. She is also in charge of the netball teams that compete on week days at Te Pai netball courts.

### **Stationery**

Children are provided with a stationery pack at the start of the year which contains all the necessary items needed for their year level. This process has proven to be popular with our community and enables teachers to establish book work expectations straight away. We ask whānau for a contribution of \$10.00 to go towards the costs associated with purchasing the packs.

### **Swimming**

Although we do not have a school pool we recognise that water safety and swimming is an important part of our physical education programme. We have recently been able to access free lessons as part of the Greater Auckland Aquatics Plan (GAAP) for all year 3-6 children and Glen Eden Intermediate. The free sessions are delivered over a 2 week period in term 4.

### **Traffic Wardens**

Year 6 students are timetabled on every afternoon as traffic wardens at our 3 key road crossings. A member of staff is also on duty to supervise the crossings and make sure all our children cross the road safely.

